



# THE LANGHAM

CHICAGO

The Langham, Chicago delivers contemporary design, refined service and 15,000 ft<sup>2</sup> of event space, complemented with state-of-the-art technology to ensure the success of any conference or function.

Function Room Name	Floor	Gross Area Square Feet	Ceiling Height Feet	Dimensions Feet	Theater	Classroom (3 per 6ft)	Classroom (2 per 6ft)	Banquet Rounds (66" rounds)	Crescent 7ppl	Reception	Conference	U-Shape (3 per 6ft)
Devonshire & Cambridge (including pre-function space)	3									356		
Devonshire Ballroom	3	4,880	22	122 x 40	260*	170	96	260	182	260*	102	120
Devonshire I	3	1,280	22	32 x 40	50	46	32	50	42	50	24	24
Devonshire II	3	1,200	22	30 x 40	50	46	32	50	35	50	24	24
Devonshire III	3	1,240	22	31 x 40	50	36	32	50	35	50	24	24
Devonshire IV	3	1,160	22	29 x 40	50	40	24	50	28	50	24	24
Devonshire I/II	3	2,480	22	62 x 40	100	92	56	100	77	100	48	38
Devonshire II/III	3	2,440	22	61 x 40	100	82	64	100	77	100	48	38
Devonshire I/II/II	3	3,720	22	92 x 40	150	128	72	150	105	150	56	58
Devonshire III/IV	3	2,400	22	60 x 40	100	76	56	100	63	100	48	48
Cambridge	3	2,639	9'6"	91 x 29	150*	108	66	150	105	150*	60	54
Cambridge I	3	870	9'6"	30 x 29	50	36	24	50	35	56	20	16
Cambridge II	3	899	9'6"	31 x 29	50	36	24	50	35	50	20	16
Cambridge III	3	870	9'6"	30 x 29	50	24	16	40	28	50	20	16
Cambridge I/II	3	1,769	9'6"	61 x 29	100	90	48	100	70	106	40	36
Cambridge II/III	3	1,769	9'6"	61 x 29	100	60	40	90	63	100	40	36
Chelsea	2	2,400	11	93 x 29	140	80	54	130	70	150	54	60
Chelsea I	2	885	11	31 x 29	50	27	18	40	28	50	20	24
Chelsea II	2	756	11	28 x 29	60	27	18	40	28	50	20	24
Chelsea III	2	759	11	32 x 29	50	27	18	40	28	50	20	24
Chelsea I/II	2	1,641	11	60 x 29	110	54	36	80	55	100	36	42
Chelsea II/III	2	1,515	11	61 x 29	110	54	36	80	55	100	36	42
Melbourne	4	992	10	31 x 32	60	—	18	50	35	50	20	18
Piccadilly	4	902	10	22 x 41	—	—	—	—	—	—	20	—
Dover Suite	9	594	9	27 x 22	16	—	—	—	—	—	20	—
Stratton Suite	10	594	9	27 x 22	16	—	18	24	18	—	14	16
Coventry Suite	11	594	9	27 x 22	16	—	18	24	18	—	14	16
Cinema Suite	12	598	9	26 x 23	12	—	—	—	—	—	—	—
The Langham Club Board Room	12C	594	9	27 x 22	—	—	—	—	—	—	12	—

Please note that the above numbers reflect a maximum set & do not include audio visual, buffet station for meals, coffee or beverage stations, stage, dance floor or any additional items beyond the event set

All space not on 3 floor reflect maximum set with existing leather chairs and 6 x 36 wooden tables

\*The maximum numbers for Theatre sets and Reception sets are based on currently established FIRE CODE CAPACITIES by the City of Chicago.

2nd Floor - Event Space

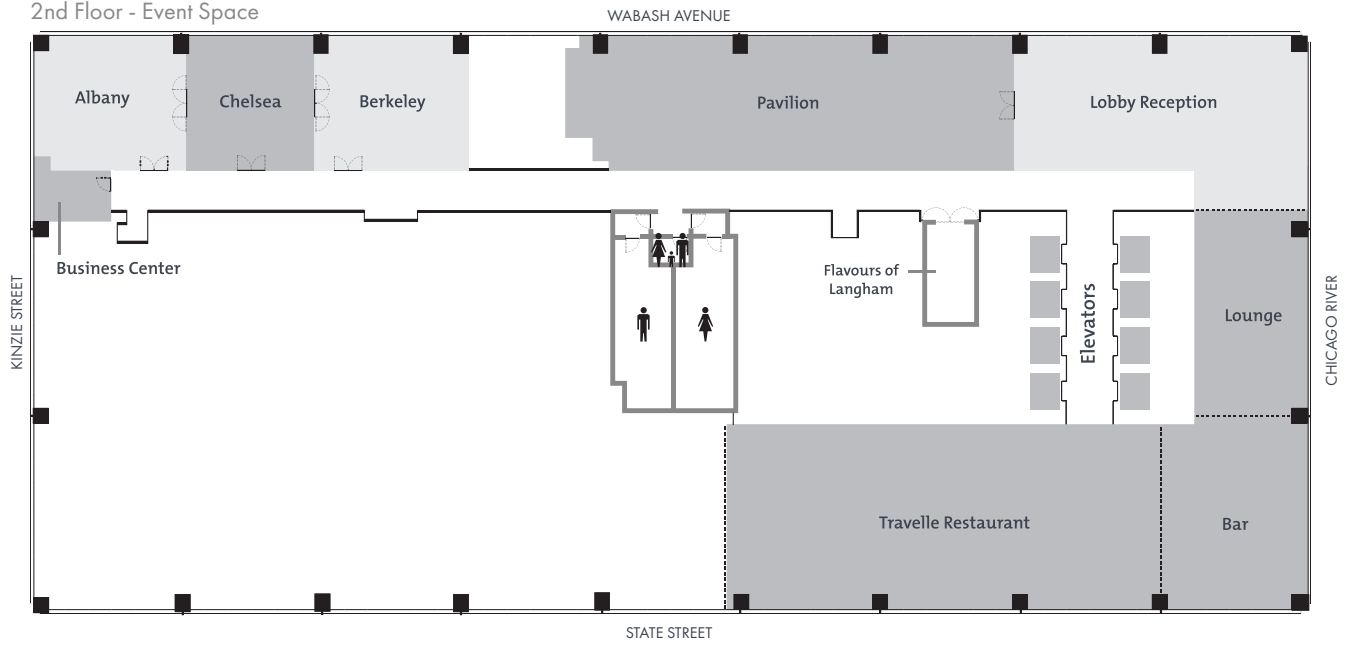

3rd Floor - Event Space

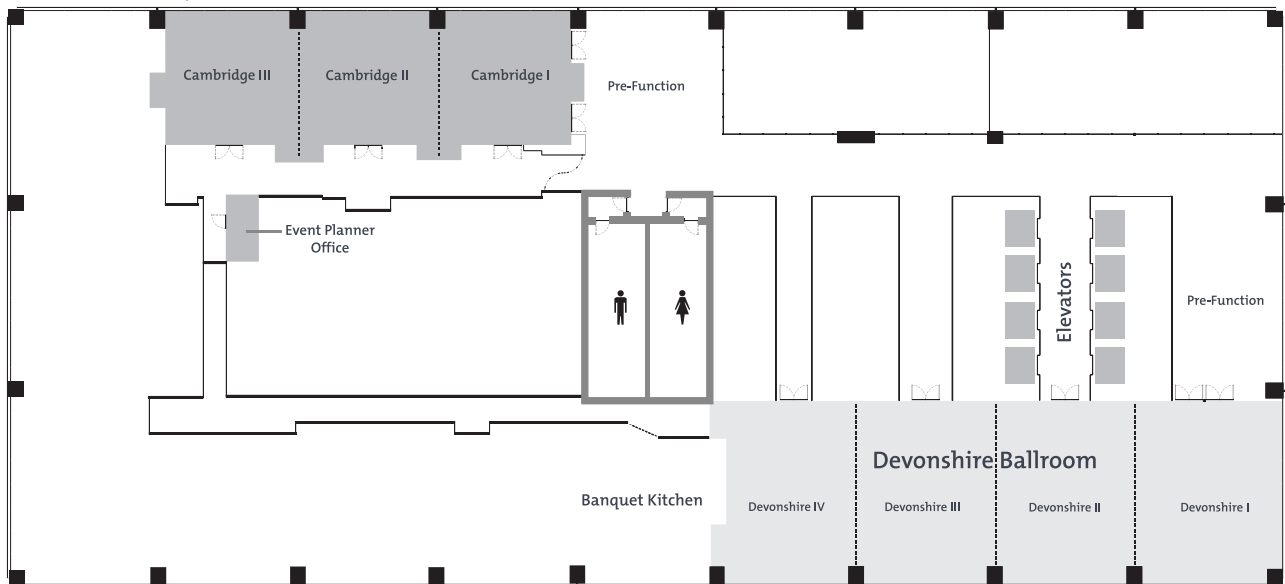

4th Floor - Chuan Spa, Health Club & Event Space

